

# 259 George Street, Sydney

## Case Study

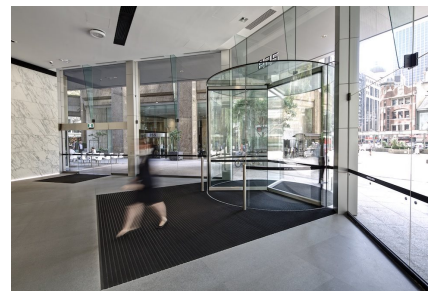

The main entrance to 259 George Street, Sydney features a 4000mm diameter x 3500mm high Diamond Series revolving door, installed by record Automatic Doors as part of wider building refurbishment work in 2013.

# 259 George Street, Sydney

## Case Study





# 259 George Street, Sydney

## Case Study

