

Caribbean Park Stage 2

Case Study

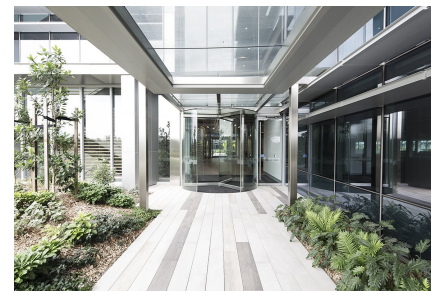

A world class office precinct in Melbourne's South-Eastern suburbs, Caribbean Park has been designed, developed, built and managed by the Spooner family, who have been dedicated in transforming the park for three generations.

Awarded the Best Business Park as part of the Property Council Australia Innovation and Excellence Awards for 2018, the latest building in this development, 26 Lake Caribbean Boulevard, offers cutting edge smart office design nestled within beautifully landscape gardens.

For the main entries, record Automatic Doors was engaged to supply and install four Diamond Series revolving doors to provide an air locked entry to help in the meeting of energy efficiency target. For ease of installation and ongoing service and maintenance requirements the drive motors for these doors were mounted to the underside of the concrete slab with access from the carpark level below.

To minimise visual disruption the standard freestanding bollards used for the mounting of the slow speed and emergency stop buttons were deleted with the slow speed button not fitted externally, after consultation with the building certifier, and the emergency stop and slow speed buttons mounted to wall cladding within the lobby next to each revolving door.

For the adjacent frameless glass swing doors at each entrance, necessary for meeting disable access and emergency egress requirements, record supplied and installed their C 127 concealed automatic swing door operator, mounted within the floor setdown with a finished stainless steel cover plate for operator access.

After completion of this stage of the Caribbean Park development, record Automatic Doors now has a total of 10 revolving doors across the first two stages as well as the cafe and function centre within the precinct.

Caribbean Park Stage 2

Case Study

