

31 Dalmore Drive, Scoresby

Case Study

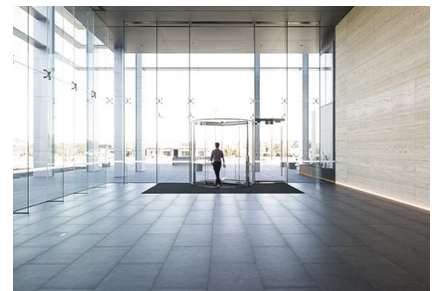
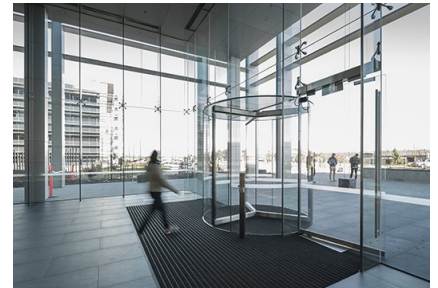

Our proud association with the rapidly expanding Caribbean Park development in Scoresby continues with Stage 3 at 31 Dalmore Drive and 36 Lakeview Drive.

Each site has two 2700mm diameter record Diamond Series revolving doors, installed to the lobby entrances at either end of the two buildings.

Low iron glass was used for increased clarity and to match the surrounding frameless glass assemblies, installed by IND Windows. The drive systems were mounted to the underside of the suspended slab, with access for ongoing service and maintenance from the basement car park.

In addition to the four revolving doors, record also supply and installed C 127 floor mounted automatic swing door operators to the adjacent DDA swing doors.

31 Dalmore Drive, Scoresby

Case Study



31 Dalmore Drive, Scoresby

Case Study

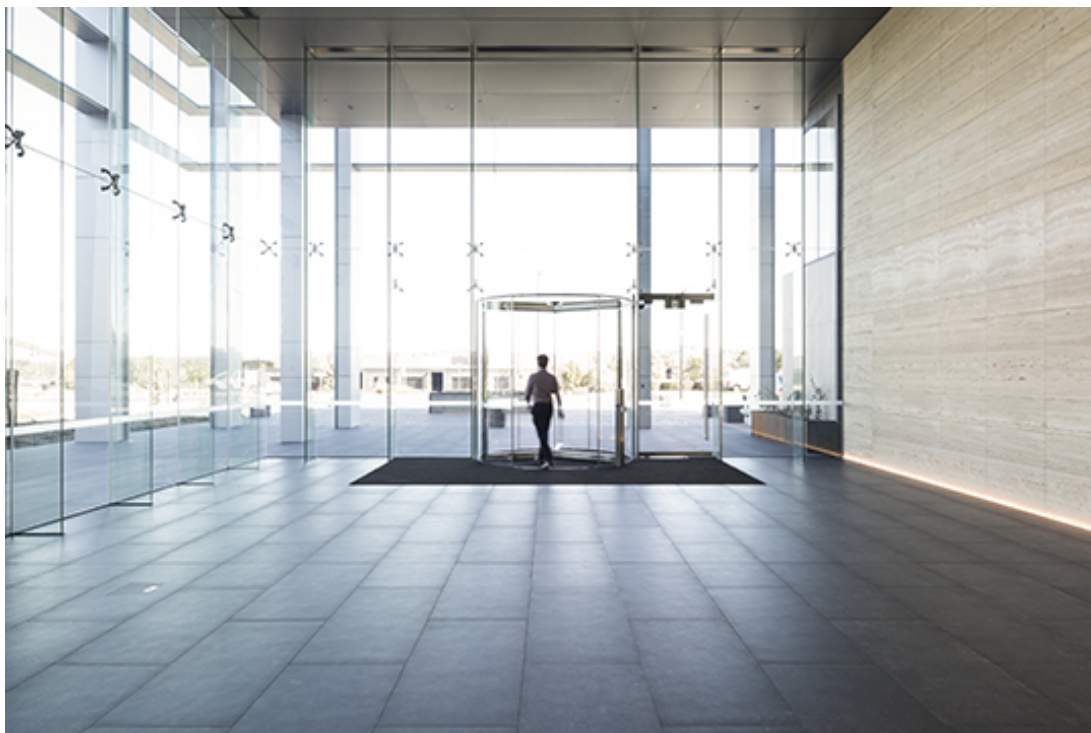

31 Dalmore Drive, Scoresby

Case Study

